

## TWO YEAR WARRANTY

REDARC Electronics warrants to the original purchaser that the product(s) on the reverse side of this sheet ("Product") will be free, under normal use and maintenance, from defects in material and workmanship for a period of TWO YEARS from the date of purchase, subject to the conditions shown below.

### 1. Warranty

Unless otherwise stated in this warranty, Redarc Electronics will at its sole discretion either replace or repair any of the Product that is defective in material or workmanship within the abovementioned period without charge to the original purchaser.

### 2. Other Warranty

Subject to any terms implied by law, this warranty contains the whole of the Redarc Electronics' obligations and any distributor and the agents, officers and employees of such distributor and of Redarc Electronics are not authorised to vary or extend the terms of the warranty. The benefits conferred by this warranty are in addition to the conditions and warranties implied by applicable legislation conferring rights upon consumers, which apply only to the extent to which they may not by law be excluded.

### 3. Exclusions

This warranty shall not apply to, or include, any of the following:

- 3.1 Any defect or failure due to accident, misuse, abuse, movement of the Product to a new site, negligence, non-observance of any of the instructions supplied with the Product including the instructions on the reverse side of this sheet ("Operating Instructions") or local regulations on the part of any user, choice of location, improper installation, configuration or connection, or faulty power supply.
- 3.2 If the Product is installed, repaired or serviced by a person who is not a qualified auto electrician or electronics technician, or if non-approved parts have been fitted.
- 3.3 Failure to obtain proper maintenance for the Product or any associated equipment or machinery.
- 3.4 Failure to pay for the products in full or comply with Redarc Electronics' Trading Terms.
- 3.5 If the Product is used other than for any reasonable purpose for which it was manufactured, or is used in a way not specified by Redarc Electronics.
- 3.6 If the original purchaser sells, leases or otherwise parts with possession of the Product.
- 3.7 Deterioration due to normal use and exposure, including abnormal environmental conditions such as lightning strike, flood and extreme heat.
- 3.8 Any freight, packing and insurance expenses relating to transportation of the Product.
- 3.9 Any expenses relating to installation and/or removal of the Product.
- 3.10 Any damage, indirect or incidental, of whatever nature.

### 4. Limitations

- 4.1 Redarc Electronics is not liable for any consequential, indirect or accidental loss or damage or for any service not expressly provided herein (including without limitation liability for any loss or damage caused by a fault in the Product or its external wiring connections) and the liability of Redarc Electronics under this warranty is limited to the repair or replacement of defective material or workmanship by a qualified auto electrician or electronics technician, provided such person and work is approved by Redarc prior to commencement. Subject to **clause 2**, Redarc Electronics is hereby excluded to the maximum extent permitted by law from all other liability in respect of the Product.
- 4.2 While Redarc Electronics warrants, where applicable, that the Product is free from defects in materials and workmanship under normal use at the time of delivery, Redarc Electronics does not warrant that the Product will meet any user specific requirements or that the operation of the Product will be uninterrupted or error-free.

### 5. Owner's Responsibilities

- 5.1 Maintenance of the Product and associated equipment and/or machinery is the responsibility of the owner. The owner must retain evidence that proper maintenance has been performed on the Product by Redarc Electronics or a qualified auto electrician or electronics technician. Claims made during the warranty term will not be accepted if resulting from lack of maintenance rather than faulty material or workmanship.
- 5.2 The owner must operate the Product in accordance with all of the Operating Instructions.
- 5.3 Upon discovery of a fault the owner must return the Product to the distributor with full details of the nature of the fault. Removal of the Product must be done by a qualified auto electrician or electronics technician to ensure that the warranty remains valid. A written report describing the circumstances of failure must accompany the returned Product with proof of purchase which clearly shows the date of such purchase by the original purchaser.
- 5.4 If the Product is found to be working satisfactorily on return to Redarc Electronics a reasonable charge will be made for the cost of testing, packing and freight. The Product will be returned on receipt of the amount charged.

## FREE TECHNICAL ASSISTANCE



THE POWER CONVERSION SPECIALISTS  
23 Brodie Road North  
Lonsdale  
South Australia 5160  
Phone: 08 8322 4848  
Fax: 08 8387 2889  
Email: [power@redarc.com.au](mailto:power@redarc.com.au)  
Web: [www.redarc.com.au](http://www.redarc.com.au)



## Redarc Electric Trailer Brake Controllers

The Redarc range of electric trailer brake controllers provide an easy to operate method of controlling electric brakes on a trailer, camper-trailer, boat trailer or caravan.

- A GREEN light from the LED indicator means that a trailer with electric brakes is plugged in.
- Application of the brakes from either the foot brake or the manual button on the controller will change the LED to a shade of RED.
- The shade of RED indicates to what level the brakes are applied.
- The adjustment knob will set the level of braking, for both the manual button and the foot brake.

**Note:- When a trailer is not connected the LED indicator will still glow RED when the brakes are applied.**

### Electric Trailer Brake Controller (EB)

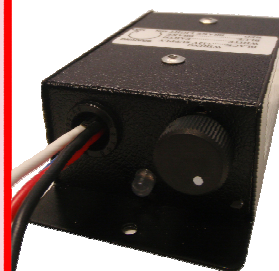
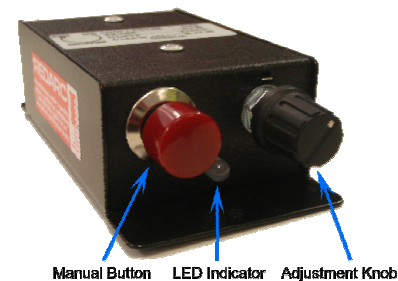

### Trailer Mount Electric Trailer Brake Controller (EBTM)

EB series brake controllers have the option of an encapsulated trailer mount unit. The EBTM is completely potted in a silicone elastomer to ensure protection against vibration and the weather. As the manual button is not needed, it has been removed and the EBTM requires an auxiliary 12V available at the trailer socket. Apart from this the unit operates as the standard EB does.

### Remote Mount Electric Trailer Brake Controller (EBRH)

The EBRH model comes with the LED and controls remote from the unit. This allows mounting of the controls up to 500mm away from the main unit. The controls are small enough to be mounted in the dash through a standard push-out switch panel. The main unit can be mounted out of sight, and the controls will have minimal visual impact on the vehicle. The braking gain adjustment knob and the manual override pushbutton are the same control, which allows the operator to adjust the braking level whilst operating the manual override function.

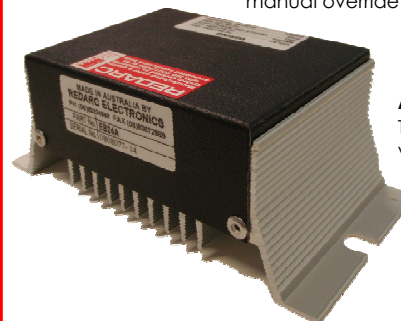
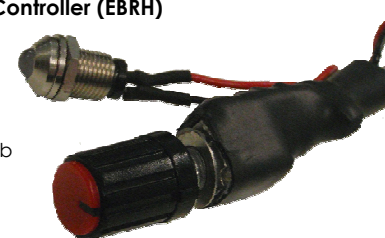

### Adaptor for 24V Vehicles

The EB24A is designed to operate a 12V brake controller in a 24V vehicle.

- Allows 24V brake lights to switch on the EB.
- Allows EB manual button to switch on 24V brake lights
- Provides 24-12V charging so braking power can be taken from one battery.

FREE TECHNICAL ASSISTANCE, contact Redarc Electronics

Ph (08) 8322 4848, Fax (08) 8387 2889

or Email [power@redarc.com.au](mailto:power@redarc.com.au)

Specifications are subject to change without notification.

### Specifications

<b>Number Of Axles</b>	All EB Models are designed for 1, 2 or 3 Axles. Rated to 18A		
<b>Dimensions</b>	Brake Controllers: 50Wx100Lx30H(mm)	24V Adaptor: 135Wx70Lx50H(mm)	
<b>Weight</b>	EB & EBRH - 200g	EBTM - 300g	EB24A - 500g
<b>Mounting</b>	Brake Controllers - 2 x M3 Holes		
<b>Indication</b>	Brake Controllers; Green LED indicates a trailer connection; Red LED indicates level of braking force.		
<b>Connections</b>	Flying leads, refer to diagrams opposite.		
<b>Input Voltage</b>	All brake controllers accept only 12V input. For 24V application EB24A is needed.		
<b>Protection</b>	Input reverse polarity protection, Short circuit protected.		
<b>Current Limit</b>	Electronic, self-resetting.		
<b>Efficiency</b>	> 90%		
<b>Ambient Temperature</b>	OPERATING: 0°C to 60°C STORAGE: -10°C to 70°C		

### Setting Electric Brakes to Desired Level

#### Setup:

Set the braking force to maximum level by adjusting the knob completely CLOCKWISE.  
(Warning - during travel, this may cause very harsh braking, and possibly lock the trailer brakes. The initial setup should be done on a clear, quiet road whilst travelling slowly)

#### Driving Test:

Begin by taking off slowly, maintain a constant speed then gently apply the vehicle's brakes. The 'Electric Brake Controller' will engage and this will apply brakes to the trailer being towed.

#### Adjustment:

Now adjust the braking force, while travelling, by adjusting the knob gradually ANTI-CLOCKWISE until the brakes engage at a comfortable level.

The ideal braking force will vary in relation to the type and condition of the trailer brakes, and the amount of load on the trailer.

### Operation

EBRH operation.



Green LED indicates a trailer with electric brakes is connected.

Yellow LED indicates adjustment set at halfway mark & brakes applied.

Red LED indicates braking at full level of adjustment and brakes applied.

**TURNING** the adjustment knob clockwise will **INCREASE** the braking force.



**PUSHING** the adjustment knob **IN** will apply the brakes to the trailer only (at the set level) and will also apply the brake lights on the vehicle.

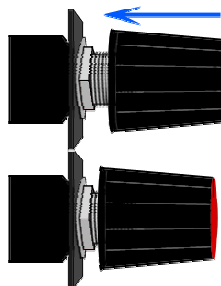

### Installation

EBRH Controls & LED Installation

1. Remove LED from Bezel assembly.

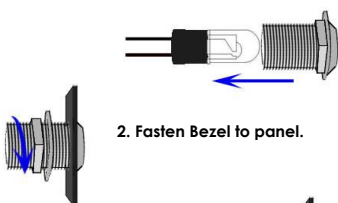

2. Fasten Bezel to panel.

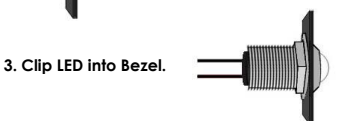

3. Clip LED into Bezel.



1. Remove Knob, Nut & Washer from Pot.

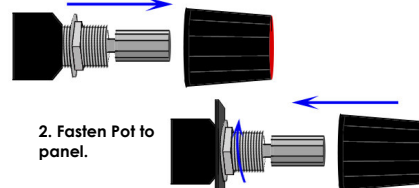

2. Fasten Pot to panel.

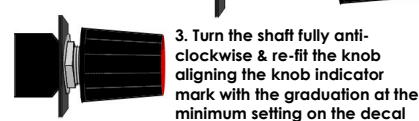

3. Turn the shaft fully anti-clockwise & re-fit the knob aligning the knob indicator mark with the graduation at the minimum setting on the decal provided.

### Wiring Instruction

#### EB, EBRH & EBTM wiring instruction.

Ensure a 25A fuse (not supplied) is fitted close to the battery positive terminal.

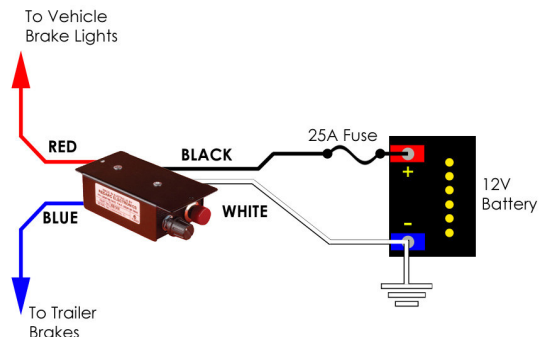

#### EB24A wiring instruction.

Ensure that 10A & 25A fuses (not supplied) are installed close to the battery terminal.

